

Mounting instructions for Thermolux integrated door for do it yourself installation.

Product information

Thermolux integrated cooling room door is intended for use in cooling rooms for private households. The integrated cooling room door is delivered as a ready mounted door in a steel frame and insulated steel bracket up/down and insulated plastic profiles on the long sides. The door is comprised of zinc-plated steel plates with foodsafe coating, edge profile in PVC and is insulated with 40 mm polyurethane foam. The door seals with a replaceable magnetic strip and can be hung both on the right and left side by turning the door up and down. Thermocold KFD AS can also supply integrated doors for special measurements. We also supply cooling units in different sizes and types, shelves in different lengths, in addition to shelf rails and shelf brackets

Important information

Thermocold KFD AS's consumer products are sold for normal use in private households. To ensure correct installation and use and also extend the product's lifespan, you must carefully read through this mounting and installation instruction before you start mounting the door. The manufacturer takes no responsibility for damage caused if the instructions in the mounting and usage instruction are not followed. Thermocold KFD AS makes certain reservations regarding any printing errors in this mounting and usage instruction and reserves the right to change product specifications.

Dimensions and technical specifications

- Dimensions door with frame 605 mm x 1955 mm +18 mm surrounding flange
- Weight, net: 19 kg
- External material door foodsafe plastic coated steel with polyurethane core - Frame in enamelled steel
- Plastic profiles frame in PVC
- Replaceable magnetic strip

Parts list

- Complete door with frame
- Insulated brackets short side
- Insulated frame profiles 2 pcs.
- Fixing screws 4 pcs.
- Joint cartridge 1 pc.
- Integration set for furniture door 8 pcs. Velcro, 8 pcs. screws with washers and plastic caps

Before mounting

Check that you have all the parts against the list of parts in this mounting and usage instruction. Contact the supplier in the event of damage and missing parts. For service, see our website www.thermocold.no Check that the frame with the door is straight in the opening and seals completely. Any minimal skew can be regulated with the aid of frame out/in diagonally. If the door frame on the long

sides is somewhat concave/oval in relation to the door straighten it with the aid of a shim or similar between the door and the frame side or between the element and door frame. Allow the door frame with door closed to harden for a minimum of 8 hours with the door and frame in the correct position, without putting strain on the openings. If necessary, the hinges can also be adjusted sideways by loosening the hinges in the frame with a 4 mm Allen key.

Useful material and tools that are not included

- 3-4 mm drill, 4 mm Allen key, sealant gun and drill

Do it yourself installation room

1. Choose the hinge side on the door by turning the door frame with the door.
2. Try the door with the frame in the opening and ensure that it fits
3. Take it out again and place a 4-5 mm thick strip of sealant (cartridge included) in the opening approx. 1 cm from the edge and in on each side and in the front up and down, so that you have a thick stripe around the entire door opening.
4. Insert the door frame with the door and fix the door frame in the roof with screws on the top side. - See picture 2.
5. Seal around the entire frame from the inside so that it becomes tight (figure 4).
6. Place the long plastic profile with insulation into the track on the frame and press it into place (snap in). - See picture 1.
7. Check that the frame with the door is straight in the opening and seals completely. Any skew in the timber can be regulated with the aid of the frame out/in. If the door frame on the long sides is somewhat concave/oval in relation to the door/timber, then place a piece of paper or similar between the door and the frame side or between the timber and door frame. Allow the door frame with the door closed to harden for a minimum of 8 hours with the door and frame in the correct position, without putting strain on the openings. If necessary, the hinges can also be adjusted sideways using a 4 mm Allen key.
8. Screw and tighten the insulated brackets up/down. - See picture 3. Shelves in the door. Door shelves can be ordered for mounting on the door. 4 pcs. shelves and 2 plastic brackets. First screw on and tighten a bracket on the hinge side next to the edge on the plastic profile and thread in the shelf in the track. Thread the second bracket on the shelf and press somewhat against each other before it is screwed tight at the correct height with the first bracket.

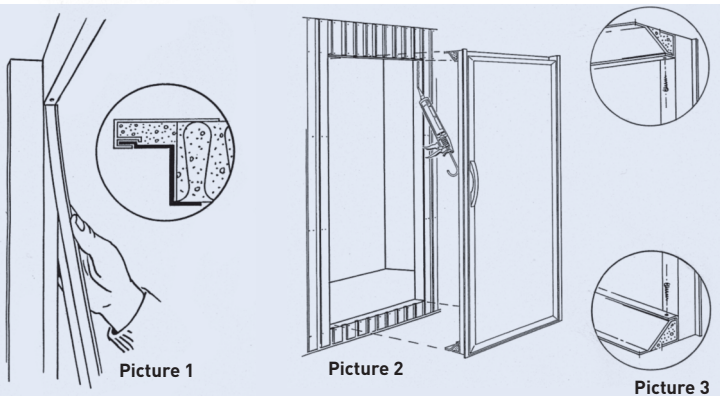
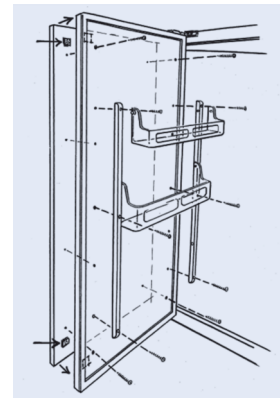

Integration

First fix YOUR handle on the furniture plate. The furniture door is fixed first using Velcro. Approx. 50 mm in from the edge of the door. When the furniture door is in the correct position fix it from the inside with the accompanying screws with plastic washer for decorative cup. First drill a hole with a 3-4 mm drill bit in the cooling door 40 mm in from the edge long side and 150 mm in from the edge short side for screw brackets. Pay regard to the thickness on the furniture door by measuring the length of the screw. If the furniture door is 2-part then first fix the lower part and place a spacer insert between the fronts (such as paper) so that this becomes visually like the other furniture fronts. BRUSHED STEEL FRONT: This is fixed up/down and the handle is placed on with screws.